

201
201
201
201
201

AN ORDINANCE TO DETERMINE THE ASSESSMENTS AGAINST THE PROPERTY SPECIFICALLY BENEFITTED BY THE SOUTH RESIDENTIAL SANITARY SEWER IMPROVEMENTS.

Recitals:

1. The South Residential Sanitary Sewer District, as referred to in this ordinance and previous resolutions and ordinances, is that area outlined on the accompanying maps marked Exhibit A.
2. Preliminary resolutions and ordinances prescribing the manner and extent of the improvements are set forth in Resolutions 399 and 407 and in Ordinance No. 2723.
3. The assessments set forth in the following ordinance are based upon the report and recommendation of the City Engineer in compliance with Ordinance No. 2723.

THE PEOPLE OF THE CITY OF ALBANY DO ORDAIN AS FOLLOWS:

Section 1: The total cost of the sewer improvements in the South Residential Sanitary Sewer District is hereby determined to be \$143,180.70. Of this amount the following is determined to be the amount to be paid by the City for trunk sewer improvements and the amount to be assessed against the property particularly benefited thereby:

City's share:			
Construction costs of trunks	\$67,406.56		
1% engineer, legal and Administrative costs	<u>10,110.98</u>		
		\$77,517.54	
Benefited property's share:			
Construction costs of laterals	\$57,098.40		
1% engineer, legal and administrative costs	<u>8,564.76</u>		
			65,663.16
TOTAL COSTS			\$143,180.70

Section 2: The proportionate share to be assessed against the property specifically benefited thereby is hereby determined to be on the basis of \$0.0253 per square foot and the assessment shall be in the amount set forth after the description of the particular property.

<u>Name of Person on Assessment Roll</u>	<u>Description of Property</u>	<u>Area Assessed</u>	<u>Amount of Assessment</u>
Leroy W. Govro 2225 S. Main Street	N. 77.47' of W. 200' Lot 1 Morningside Tracts	7,747	\$ 196.64
Harold W. & Phyllis A. Agnew 2310 Park Terrace	S. 76' of W. 200' Lot 1 Morningside Tracts	7,600	192.91
Robert F. & LaDona Louise Daly 2430 Denver Place	E. 50' Lot 1 Morningside Tracts	5,000	126.91
Robert F. & LaDona Louise Daly	W. 10' of E. 30' Lot 2 Morningside Tracts	1,000	25.38
Milton B. & Erika L. Hall P. O. Box 143	W. 120' Lot 2 Morningside Tracts	12,000	304.59
Verna Miller 1115 E. 23rd Ave.	W. 100' of E. 130' Lot 2 Morningside Tracts	10,000	253.83
Robert & Arlene Dahl 1925 Williamette Street	E. 20' Lot 2 Morningside Tracts	2,000	50.77
Robert & Arlene Dahl	W. 50' Lot 3 Morningside Tracts	5,000	126.91
Erman K. & Erma E. Johnston 2210 S. Geary Street	E. 150' Lot 3 Morningside Tracts	15,000	380.74
Erman K. & Erma E. Johnston	E. 150' Lot 4 Morningside Tracts	15,347	389.55
Robert F. & LaDona Louise Daly 2430 Denver Place	W. 50' Lot 4 Morningside Tracts	5,000	126.92
Erman K. & Erma E. Johnston 2210 S. Geary Street	Lot 5 Morningside Tracts	29,979	760.95
Frank Sloan & Virginia Dannels 1110 E. 23rd Avenue	W. 93' Lot 6 Morningside Tracts	9,500	241.14
Frank E. & Aillean Block 1130 E. 23rd Avenue	E. 25' Lot 6 Morningside Tracts	2,500	63.46

<u>Name of Person on Assessment Roll</u>	<u>Description of Property</u>	<u>Area Assessed</u>	<u>Amount of Assessment</u>
Harold & Dorothy Ann Jackson 1120 E. 23rd Avenue	E. 80' of W. 175' Lot 6 Morningside Tracts	8,000	\$ 201.00
Clyde M. & Carolyn Rogers 1115 E. 24th Avenue	E. 75' of W. 155' Lot 7 Morningside Tracts	7,500	190.37
Gene & Barbara E. Asai 1105 E. 24th Avenue	W. 80' Lot 7 Morningside Tracts	8,000	203.06
Glenn L. & Ada Lou Galloway 1125 E. 24th Avenue	E. 45' L t 7 Morningside Tracts	4,500	114.22
Glenn L. & Ada Lou Galloway	W. 55' Lot 8 Morningside Tracts	5,500	139.61
Robert W. & LaVada Erner 1135 E. 24th Avenue	W. 95' of E. 195' Lot 8 Morningside Tracts	9,500	241.14
Forrest D. & Bertha L. Liddle 2340 S. Oak Street	E. 100' Lot 8 Morningside Tracts	10,000	253.83
Frank E. & Aileen Block 1130 E. 23rd Avenue	W. 45' Lot 9 Morningside Tracts	4,500	114.22
Kenneth A. & Zella Perfect 1140 E. 23rd Avenue	E. 70' of W. 115' Lot 9 Morningside Tracts	7,000	177.68
William R. & Gracia J. Jordan 169 Bodie St. Roseburg, Oregon	W. 70' of E. 135' Lot 9 Morningside Tracts	7,000	177.68
William T. & Catherine F. Peters 1160 E. 23rd Avenue	E. 65' Lot 9 Morningside Tracts	6,500	164.99
Scharpf's Twin Oak Builders Supply Co. 760 E. 2nd Ave.	Lot 10 Morningside Tracts	27,764	704.73
Robert F. & LaDona Louise Daly 2430 Denver Place	Lot 11 Morningside Tracts	19,757	501.49
Robert F. & LaDona Louise Daly	Lot 12 Morningside Tracts	19,757	501.49
Robert F. & LaDona Louise Daly	Lot 13 Morningside Tracts	19,757	501.49
Robert F. & LaDona Louise Daly	Lot 14 Morningside Tracts	19,757	501.49
Robert F. & LaDona Louise Daly & Orris L. & Jewel A. Bowman 330 N. Harrison Street	Lot 1 So. Add. to Morningside Tract	20,000	507.65
Robert F. & LaDona Louise Daly Orris L. & Jewel A. Bowman	Lot 2 So. Add. to Morningside Tract	17,500	444.20
Norman D. & Elaine N. Cahill 2540 S. Main Street	S. 50' Lot 2 So. Add. to Morningside Tract	5,000	126.91
Norman D. & Elaine N. Cahill	N. 25' Lot 3 So. Add. to Morningside Tract	2,500	63.46
Luella M. Herman 721 N. 17th St. Corvallis, Oregon	S. 175' Lot 3 So. Add. to Morningside Tract	17,500	444.20
Luella M. Herman	N. 5' Lot 4 So. Add. to Morningside Tract	500	12.69
Robert F. & LaDona Louise Daly & Orris L. & Jewel A. Bowman 330 N. Harrison Street	S. 214.35' Lot 4 So. Add. to Morningside Tract	21,435	544.08
Robert F. & LaDona Louise Daly & Orris L. & Jewel A. Bowman	Lot 5 So. Add. to Morningside Tract	14,500	368.05
Robert F. & LaDona Louise Daly & Orris L. & Jewel A. Bowman	Lot 6 Sq. Add. to Morningside Tract	14,500	368.05
Robert F. & LaDona Louise Daly & Orris L. & Jewel A. Bowman	Lot 7 So. Add. to Morningside Tract	23,150	587.61
Robert F. & LaDona Louise Daly & Orris L. & Jewel A. Bowman	Lot 8 So. Add. to Morningside Tract	20,000	507.65
Robert F. & LaDona Louise Daly & Orris L. & Jewel A. Bowman	Lot 9 So. Add. to Morningside Tract	24,300	611.11

<u>Name of Person on Assessment Roll</u>	<u>Description of Property</u>	<u>Area Assessed</u>	<u>Amount of Assessment</u>
Robert F. & LaDonna Louise Daly & Orris L. & Jewel A. Bowman	Lot 10 So. Add. to Morningside Tract	20,000	\$ 507.66
Robert F. & LaDonna Louise Daly & Orris L. & Jewel A. Bowman	Lot 11 So. Add. to Morningside Tract	20,000	507.66
Robert F. & LaDonna Louise Daly & Orris L. & Jewel A. Bowman	Lot 12 So. Add. to Morningside Tract	20,000	507.65
Robert F. & LaDonna Louise Daly & Orris L. & Jewel A. Bowman	Lot 13 So. Add. to Morningside Tract	22,500	571.11
Robert F. & LaDonna Louise Daly & Orris L. & Jewel A. Bowman	Lot 14 So. Add. to Morningside Tract	22,500	571.11
Robert F. & LaDonna Louise Daly & Orris L. & Jewel A. Bowman	Lot 15 So. Add. to Morningside Tract	25,000	634.57
Robert F. & LaDonna Louise Daly & Orris L. & Jewel A. Bowman	Lot 16 So. Add. to Morningside Tract	25,000	634.57
Robert F. & LaDonna Louise Daly & Orris L. & Jewel A. Bowman 28th St. vacated on Oak St.	So. Add. to Morningside Tract	5,000	126.92
28th St. vacated on Main St.		5,000	126.91
H. L. & Hazel Fair Rt. 2 Box 392	S $\frac{1}{2}$ Block 10 Hollywood Acres	16,632.50	422.18
Charles & Retta Mae Draper 1715 S. Hill Street	N $\frac{1}{2}$ Block 10, Ex. N. 20' of E. 130.95' & N. 166.325' of W. 130.95' Hollywood Acres	14,632.50	371.42
Floyd H. & Shirley R. Goin 2400 S. Hill Street	N. 166.325' of W. 130.95' & N. 20' of E. 139.95' Hollywood Acres Block 10	16,632.50	422.18
Owen & Mary G. Beam 225 W. 2nd Avenue	Block 11 Hollywood Acres	33,265	844.36
John A. & Margaret E. Boock 532 W. 7th Avenue	Block 12 Hollywood Acres	39,580	1,004.65
Owen Beam 225 W. 2nd Avenue	Block 13 Hollywood Acres	40,570	1,029.78
Laird & Jerales M. Hyde 2755 S. Hill Street	S $\frac{1}{2}$ of Block 14 Ex. W. 200' of N. 136.25' Hollywood Acres	16,632.5	422.18
Owen Beam 225 W. 2nd Avenue	N $\frac{1}{2}$ Block 14 Hollywood Acres	16,632.5	422.18
Owen Beam	Ex. N. 20' Block 15 Hollywood Acres	31,265	793.59
J. L. Rodgers 341 E. 4th Avenue	Lot 1 Block 1 2nd Add. to Rodgers Acres	7,052	179.00
J. L. Rodgers	Lot 2 Block 1 2nd Add. to Rodgers Acres	7,500	190.37
J. L. Rodgers	Lot 3 Block 1 2nd Add. to Rodgers Acres	7,500	190.37
J. L. Rodgers	Lot 4 Block 1 2nd Add. to Rodgers Acres	7,500	190.37
J. L. Rodgers	Lot 5 Block 1 2nd Add. to Rodgers Acres	7,500	190.37
J. L. Rodgers	Lot 6 Block 1 2nd Add. to Rodgers Acres	7,500	190.37
J. L. Rodgers	Lot 7 Block 1 2nd Add. to Rodgers Acres	7,500	190.37
Jack & Barbara Draper 1715 S. Hill Street	Lot 8 Block 1 2nd Add. to Rodgers Acres	7,500	190.37
Jack & Barbara Draper	Lot 9 Block 1 2nd Add. to Rodgers Acres	7,500	190.37
Jack & Barbara Draper	Lot 10 Block 1 2nd Add. to Rodgers Acres	7,500	190.37
Jack & Barbara Draper	Lot 11 Block 1 2nd Add. to Rodgers Acres	7,500	190.38
Jack & Barbara Draper	Lot 12 Block 1 2nd Add. to Rodgers Acres	7,128	180.93
Jack & Barbara Draper	Lot 1 Block 2 2nd Add. to Rodgers Acres	8,312	216.06

<u>Name of Person on Assessment Roll</u>	<u>Description of Property</u>	<u>Area Assessed</u>	<u>Amount of Assessment</u>
J. L. Rodgers 341 E. 4th Ave.	Lot 2 Block 2 2nd Add. to Rodgers Acres	7,920	\$ 201.09
Jack & Barbara Draper 1715 S. Hill Street	Lot 3 Block 2 2nd Add. to Rodgers Acres	7,300	190.37
J. L. Rodgers 341 E. 4th Ave.	Lot 4 Block 2 2nd Add. to Rodgers Acres	7,500	190.37
J. L. Rodgers	Lot 5 Block 2 2nd Add. to Rodgers Acres	7,100	180.22
Jack & Barbara Draper 1715 S. Hill Street	Lot 6 Block 2 2nd Add. to Rodgers Acres	7,000	177.68
Jack & Barbara Draper	Lot 7 Block 2 2nd Add. to Rodgers Acres	7,100	180.22
J. L. Rodgers 341 E. 4th Ave.	Lot 1 Block 3 2nd Add. to Rodgers Acres	7,588	192.60
J. L. Rodgers	Lot 2 Block 3 2nd Add. to Rodgers Acres	7,288	184.99
J. L. Rodgers	Lot 3 Block 3 2nd Add. to Rodgers Acres	7,500	190.37
J. L. Rodgers	Lot 4 Block 3 2nd Add. to Rodgers Acres	7,500	190.37
J. L. Rodgers	Lot 5 Block 3 2nd Add. to Rodgers Acres	7,100	180.22
J. L. Rodgers	Lot 6 Block 3 2nd Add. to Rodgers Acres	7,000	177.68
J. L. Rodgers	Lot 7 Block 3 2nd Add. to Rodgers Acres	7,100	180.22
J. L. Rodgers	Lot 1 Block 4 2nd Add. to Rodgers Acres	6,579	166.99
J. L. Rodgers	Lot 2 Block 4 2nd Add. to Rodgers Acres	6,300	159.91
J. L. Rodgers	Lot 3 Block 4 2nd Add. to Rodgers Acres	6,300	159.91
J. L. Rodgers	Lot 4 Block 4 2nd Add. to Rodgers Acres	6,300	159.91
J. L. Rodgers	Lot 5 Block 4 2nd Add. to Rodgers Acres	6,300	159.91
J. L. Rodgers	Lot 6 Block 4 2nd Add. to Rodgers Acres	6,300	159.91
J. L. Rodgers	Lot 7 Block 4 2nd Add. to Rodgers Acres	6,300	159.92
J. L. Rodgers	Lot 8 Block 4 2nd Add. to Rodgers Acres	6,300	159.91
J. L. Rodgers	Lot 9 Block 4 2nd Add. to Rodgers Acres	6,300	159.91
J. L. Rodgers	Lot 10 Block 4 2nd Add. to Rodgers Acres	6,300	159.91
J. L. Rodgers	Lot 11 Block 4 2nd Add. to Rodgers Acres	6,300	159.91
J. L. Rodgers	Lot 12 Block 4 2nd Add. to Rodgers Acres	6,300	159.91
J. L. Rodgers	Lot 13 Block 4 2nd Add. to Rodgers Acres	6,480	164.49
J. L. Rodgers	Lot 14 Block 4 2nd Add. to Rodgers Acres	6,480	164.48
J. L. Rodgers	Lot 15 Block 4 2nd Add. to Rodgers Acres	6,300	159.91
J. L. Rodgers	Lot 16 Block 4 2nd Add. to Rodgers Acres	6,300	159.91
J. L. Rodgers	Lot 17 Block 4 2nd Add. to Rodgers Acres	6,300	159.91
J. L. Rodgers	Lot 18 Block 4 2nd Add. to Rodgers Acres	6,300	159.91
J. L. Rodgers	Lot 19 Block 4 2nd Add. to Rodgers Acres	6,300	159.92
J. L. Rodgers	Lot 20 Block 4 2nd Add. to Rodgers Acres	6,300	159.91
J. L. Rodgers	Lot 21 Block 4 2nd Add. to Rodgers Acres	6,300	159.91
J. L. Rodgers	Lot 22 Block 4 2nd Add. to Rodgers Acres	6,300	159.91
J. L. Rodgers	Lot 23 Block 4 2nd Add. to Rodgers Acres	6,300	159.91
J. L. Rodgers	Lot 24 Block 4 2nd Add. to Rodgers Acres	6,300	159.91
J. L. Rodgers	Lot 25 Block 4 2nd Add. to Rodgers Acres	6,300	159.92
J. L. Rodgers	Lot 26 Block 4 2nd Add. to Rodgers Acres	6,652.80	168.87

<u>Name of Person on Assessment Roll</u>	<u>Description of Property</u>	<u>Area Assessed</u>	<u>Amount of Assessment</u>
Scharpf's Twin Oaks Builders Supply Co. 160 E. 2nd Ave.	Lot 1 Block 5 2nd Add. to Rodgers Acres	7,169	\$ 181.97
Scharpf's Twin Oaks Builders Supply Co.	Lot 2 Block 5 2nd Add. to Rodgers Acres	7,500	190.37
Scharpf's Twin Oaks Builders Supply Co.	Lot 3 Block 5 2nd Add. to Rodgers Acres	7,500	190.37
Scharpf's Twin Oaks Builders Supply Co.	Lot 4 Block 5 2nd Add. to Rodgers Acres	7,500	190.37
Scharpf's Twin Oaks Builders Supply Co.	Lot 5 Block 5 2nd Add. to Rodgers Acres	7,500	190.37
Jack & Barbara Draper 1715 S. Hill Street	Lot 6 Block 5 2nd Add. to Rodgers Acres	7,500	190.37
Howard L. & Elna J. Maloney Box 546, Residsburg, Cal.	Lot 7 Block 5 2nd Add. to Rodgers Acres	7,500	190.37
Howard L. & Elna J. Maloney	Lot 8 Block 5 2nd Add. to Rodgers Acres	7,500	190.37
Howard L. & Elna J. Maloney	Lot 9 Block 5 2nd Add. to Rodgers Acres	7,500	190.37
Howard L. & Elna J. Maloney	Lot 10 Block 5 2nd Add. to Rodgers Acres	7,500	190.37
Howard L. & Elna J. Maloney	Lot 11 Block 5 2nd Add. to Rodgers Acres	7,500	190.37
Howard L. & Elna J. Maloney	Lot 12 Block 5 2nd Add. to Rodgers Acres	7,206	182.91
Jack & Barbara Draper 1715 S. Hill Street	Lot 1 Block 6 2nd Add. to Rodgers Acres	7,100	180.22
Jack & Barbara Draper	Lot 2 Block 6 2nd Add. to Rodgers Acres	7,000	177.68
J. L. Rodgers 341 E. 4th Ave.	Lot 3 Block 6 2nd Add. to Rodgers Acres	7,100	180.22
J. L. Rodgers	Lot 4 Block 6 2nd Add. to Rodgers Acres	7,500	190.37
Jack & Barbara Draper 1715 S. Hill Street	Lot 5 Block 6 2nd Add. to Rodgers Acres	7,500	190.37
J. L. Rodgers 341 E. 4th Ave.	Lot 1 Block 7 2nd Add. to Rodgers Acres	7,100	180.22
Howard L. & Elna J. Maloney Box 546, Healdsburg, Cal.	Lot 2 Block 7 2nd Add. to Rodgers Acres	7,000	177.68
Howard L. & Elna J. Maloney	Lot 3 Block 7 2nd Add. to Rodgers Acres	7,100	180.22
Howard L. & Elna J. Maloney	Lot 4 Block 7 2nd Add. to Rodgers Acres	7,500	190.37
J. L. Rodgers 341 E. 4th Ave.	Lot 5 Block 7 2nd Add. to Rodgers Acres	7,500	190.37
J. L. Rodgers	Lot 1 Block 8 2nd Add. to Rodgers Acres	7,486	190.01
J. L. Rodgers	Lot 2 Block 8 2nd Add. to Rodgers Acres	7,000	177.68
J. L. Rodgers	Lot 3 Block 8 2nd Add. to Rodgers Acres	7,000	177.68
J. L. Rodgers	Lot 4 Block 8 2nd Add. to Rodgers Acres	7,000	177.68
J. L. Rodgers	Lot 5 Block 8 2nd Add. to Rodgers Acres	7,000	177.68
J. L. Rodgers	Lot 6 Block 8 2nd Add. to Rodgers Acres	7,000	177.68
J. L. Rodgers	Lot 7 Block 8 2nd Add. to Rodgers Acres	7,000	177.68
J. L. Rodgers	Lot 8 Block 8 2nd Add. to Rodgers Acres	7,000	177.68
J. L. Rodgers	Lot 9 Block 8 2nd Add. to Rodgers Acres	7,000	177.68
J. L. Rodgers	Lot 10 Block 8 2nd Add. to Rodgers Acres	7,000	177.68
J. L. Rodgers	Lot 11 Block 8 2nd Add. to Rodgers Acres	7,000	177.68
J. L. Rodgers	Lot 12 Block 8 2nd Add. to Rodgers Acres	7,000	177.68
J. L. Rodgers	Lot 13 Block 8 2nd Add. to Rodgers Acres	7,200	182.76

<u>Name of Person on Assessment Roll</u>	<u>Description of Property</u>	<u>Area Assessed</u>	<u>Amount of Assessment</u>
Laird & Jerrelee Hyde 2755 S. Hill Street	Lot 1A Block 8 2nd Add. to Rodgers Acres	7,200	\$ 182.75
Laird & Jerrelee Hyde	Lot 15 Block 8 2nd Add. to Rodgers Acres	7,000	177.68
Laird & Jerrelee Hyde	Lot 16 Block 8 2nd Add. to Rodgers Acres	7,000	177.68
Laird & Jerrelee Hyde	Lot 17 Block 8 2nd Add. to Rodgers Acres	7,000	177.68
Laird & Jerrelee Hyde	Lot 18 Block 8 2nd Add. to Rodgers Acres	7,000	177.68
Laird & Jerrelee Hyde	Lot 19 Block 8 2nd Add. to Rodgers Acres	7,000	177.68
Howard L. & Elna J. Maloney Box 546, Healdsburg, Cal.	Lot 20 Block 8 2nd Add. to Rodgers Acres	7,000	177.68
Jack & Barbara Draper 1715 S. Hill Street	Lot 21 Block 8 2nd Add. to Rodgers Acres	7,000	177.68
Jack & Barbara Draper	Lot 22 Block 8 2nd Add. to Rodgers Acres	7,000	177.68
Jack & Barbara Draper	Lot 23 Block 8 2nd Add. to Rodgers Acres	7,000	177.68
Jack & Barbara Draper	Lot 24 Block 8 2nd Add. to Rodgers Acres	7,000	177.68
Jack & Barbara Draper	Lot 25 Block 8 2nd Add. to Rodgers Acres	7,000	177.68
Jack & Barbara Draper	Lot 26 Block 8 2nd Add. to Rodgers Acres	7,547	191.56
Jack & Barbara Draper	Lot 18 1st Add. to Rodgers Acres	11,563	293.50
Jack & Barbara Draper	Lot 19 1st Add. to Rodgers Acres	10,000	253.83
Jack & Barbara Draper	Lot 20 1st Add. to Rodgers Acres	10,000	253.83
Jack & Barbara Draper	Lot 21 1st Add. to Rodgers Acres	10,000	253.83
Jack & Barbara Draper	Lot 22 1st Add. to Rodgers Acres	10,000	253.83
Jack & Barbara Draper	Lot 23 1st Add. to Rodgers Acres	10,000	253.83
Jack & Barbara Draper	Lot 24 1st Add. to Rodgers Acres	10,000	253.83
Jack & Barbara Draper	Lot 25 1st Add. to Rodgers Acres W. 90'	9,000	228.44
Charles R. & Retta Mae Draper 1715 S. Hill Street	Lot 1 Block 2 Rodgersdale	7,700	195.45
Charles R. & Retta Mae Draper	Lot 2 Block 2 Rodgersdale	7,700	195.45
Charles R. & Retta Mae Draper	Lot 3 Block 2 Rodgersdale	7,700	195.45
Charles R. & Retta Mae Draper	Lot 4 Block 2 Rodgersdale	7,700	195.44
Charles R. & Retta Mae Draper	Lot 5 Block 2 Rodgersdale	7,700	195.45
Charles R. & Retta Mae Draper	Lot 6 Block 2 Rodgersdale	7,700	195.45
Charles R. & Retta Mae Draper	Lot 7 Block 2 Rodgersdale	7,700	195.45
Charles R. & Retta Mae Draper	Lot 8 Block 2 Rodgersdale	8,600	218.29
William M. & Patricia M. Stratton 542 University Healdsburg, California	Lot 9 Block 2 Rodgersdale	8,600	218.29
William M. & Patricia M. Stratton	Lot 10 Block 2 Rodgersdale	7,700	195.45
Charles R. & Retta Mae Draper 1715 S. Hill Street	Lot 11 Block 2 Rodgersdale	7,700	195.45
Charles R. & Retta Mae Draper	Lot 12 Block 2 Rodgersdale	7,700	195.45
Charles R. & Retta Mae Draper	Lot 13 Block 2 Rodgersdale	7,700	195.44
Charles R. & Retta Mae Draper	Lot 14 Block 2 Rodgersdale	7,700	195.45
Charles R. & Retta Mae Draper	Lot 15 Block 2 Rodgersdale	7,700	195.45
Charles R. & Retta Mae Draper	Lot 16 Block 2 Rodgersdale	7,700	195.45

<u>Name of Person on Assessment Roll</u>	<u>Description of Property</u>	<u>Area Assessed</u>	<u>Amount of Assessment</u>
William M. & Patricia M. Stratton 342 University Healdsburg, California	Lot 1 Block 3 Rodgersdale	7,700	\$ 195.45
William M. & Patricia M. Stratton	Lot 2 Block 3 Rodgersdale	7,700	195.44
William M. & Patricia M. Stratton	Lot 3 Block 3 Rodgersdale	7,700	195.45
William M. & Patricia M. Stratton	Lot 4 Block 3 Rodgersdale	7,700	195.45
William M. & Patricia M. Stratton	Lot 5 Block 3 Rodgersdale	7,700	195.45
William M. & Patricia M. Stratton	Lot 6 Block 3 Rodgersdale	7,700	195.44
William M. & Patricia M. Stratton	Lot 7 Block 3 Rodgersdale	7,700	195.45
William M. & Patricia M. Stratton	Lot 8 Block 3 Rodgersdale	8,600	218.29
Charles R. & Retta Mae Draper 1715 S. Hill Street	Lot 9 Block 3 Rodgersdale	8,600	218.29
Charles R. & Retta Mae Draper	Lot 10 Block 3 Rodgersdale	7,700	195.45
Jack & Barbara Draper 1715 S. Hill Street	Lot 11 Block 3 Rodgersdale	7,700	195.45
Jack & Barbara Draper	Lot 12 Block 3 Rodgersdale	7,700	195.45
Jack & Barbara Draper	Lot 13 Block 3 Rodgersdale	7,700	195.45
Jack & Barbara Draper	Lot 14 Block 3 Rodgersdale	7,700	195.45
Jack & Barbara Draper	Lot 15 Block 3 Rodgersdale	7,700	195.45
Jack & Barbara Draper	Lot 16 Block 3 Rodgersdale	7,700	195.45
Jack & Barbara Draper	Lot 1 Block 4 Rodgersdale	7,845	199.13
Jack & Barbara Draper	Lot 2 Block 4 Rodgersdale	7,400	187.83
Jack & Barbara Draper	Lot 3 Block 4 Rodgersdale	7,400	187.83
Jack & Barbara Draper	Lot 4 Block 4 Rodgersdale	7,400	187.83
Jack & Barbara Draper	Lot 5 Block 4 Rodgersdale	7,400	187.83
Jack & Barbara Draper	Lot 6 Block 4 Rodgersdale	7,400	187.83
Jack & Barbara Draper	Lot 7 Block 4 Rodgersdale	7,400	187.83
Jack & Barbara Draper	Lot 8 Block 4 Rodgersdale	7,400	187.83
Jack & Barbara Draper	Lot 9 Block 4 Rodgersdale	7,400	187.83
Jack & Barbara Draper	Lot 10 Block 4 Rodgersdale	7,400	187.83
Jack & Barbara Draper	Lot 11 Block 4 Rodgersdale	7,400	187.84
Jack & Barbara Draper	Lot 12 Block 4 Rodgersdale	8,000	203.06
Jack & Barbara Draper	Lot 13 Block 4 Rodgersdale	8,000	203.06
Jack & Barbara Draper	Lot 14 Block 4 Rodgersdale	7,400	187.83
Jack & Barbara Draper	Lot 15 Block 4 Rodgersdale	7,400	187.84
Jack & Barbara Draper	Lot 16 Block 4 Rodgersdale	7,400	187.83
Jack & Barbara Draper	Lot 17 Block 4 Rodgersdale	7,400	187.83
Jack & Barbara Draper	Lot 18 Block 4 Rodgersdale	7,400	187.84
Jack & Barbara Draper	Lot 19 Block 4 Rodgersdale	7,400	187.83

<u>Name of Person on Assessment Roll</u>	<u>Description of Property</u>	<u>Area Assessed</u>	<u>Amount of Assessment</u>
Jack & Barbara Draper 1715 S. Hill Street	Lot 20 Block 4 Rodgersdale	7,400	\$ 187.83
Jack & Barbara Draper	Lot 21 Block 4 Rodgersdale	7,400	187.84
Jack & Barbara Draper	Lot 22 Block 4 Rodgersdale	7,600	187.83
Jack & Barbara Draper	Lot 23 Block 4 Rodgersdale	7,400	187.83
Jack & Barbara Draper	Lot 24 Block 4 Rodgersdale	7,938	201.49
Jack & Barbara Draper	Lot 1 Block 6 Rodgersdale	8,019	203.55
Jack & Barbara Draper	Lot 2 Block 6 Rodgersdale	7,400	187.83
Jack & Barbara Draper	Lot 3 Block 6 Rodgersdale	7,400	187.83
Jack & Barbara Draper	Lot 4 Block 6 Rodgersdale	7,400	187.83
Jack & Barbara Draper	Lot 5 Block 6 Rodgersdale	7,400	187.84
Jack & Barbara Draper	Lot 6 Block 6 Rodgersdale	7,400	187.83
Jack & Barbara Draper	Lot 7 Block 6 Rodgersdale	7,400	187.83
Jack & Barbara Draper	Lot 8 Block 6 Rodgersdale	7,400	187.84
Jack & Barbara Draper	Lot 9 Block 6 Rodgersdale	7,400	187.83
Jack & Barbara Draper	Lot 10 Block 6 Rodgersdale	7,400	187.83
Jack & Barbara Draper	Lot 11 Block 6 Rodgersdale	7,400	187.84
Jack & Barbara Draper	Lot 12 Block 6 Rodgersdale	8,000	203.06
Jack & Barbara Draper	Lot 13 Block 6 Rodgersdale	8,000	203.06
Jack & Barbara Draper	Lot 14 Block 6 Rodgersdale	7,400	187.83
Jack & Barbara Draper	Lot 15 Block 6 Rodgersdale	7,400	187.84
Jack & Barbara Draper	Lot 16 Block 6 Rodgersdale	7,400	187.83
Jack & Barbara Draper	Lot 17 Block 6 Rodgersdale	7,400	187.83
Jack & Barbara Draper	Lot 18 Block 6 Rodgersdale	7,400	187.83
Jack & Barbara Draper	Lot 19 Block 6 Rodgersdale	7,400	187.84
Jack & Barbara Draper	Lot 20 Block 6 Rodgersdale	7,400	187.83
Jack & Barbara Draper	Lot 21 Block 6 Rodgersdale	7,400	187.83
Jack & Barbara Draper	Lot 22 Block 6 Rodgersdale	7,400	187.83
Jack & Barbara Draper	Lot 23 Block 6 Rodgersdale	7,400	187.83
Jack & Barbara Draper	Lot 24 Block 6 Rodgersdale	8,093	205.43
F. J. & Hazel C. Phillips 2809 S. Marion Street	Lot 1 Block 6 Ansley Park	7,400	187.83
F. J. & Hazel C. Phillips	Lot 2 Block 6 Ansley Park	7,400	187.83
F. J. & Hazel C. Phillips	Lot 3 Block 6 Ansley Park	7,400	187.84
F. J. & Hazel C. Phillips	Lot 4 Block 6 Ansley Park	7,665	194.56
F. J. & Hazel C. Phillips	Lot 5 Block 6 Ansley Park	7,645	194.05
F. J. & Hazel C. Phillips	Lot 6 Block 6 Ansley Park	7,400	187.83
F. J. & Hazel C. Phillips	Lot 7 Block 6 Ansley Park	7,400	187.83
F. J. & Hazel C. Phillips	Lot 8 Block 6 Ansley Park	7,400	187.83
F. J. & Hazel C. Phillips	Lot 1 Block 5 Ansley Park	6,800	172.60
F. J. & Hazel C. Phillips	Lot 2 Block 5 Ansley Park	6,600	167.53
F. J. & Hazel C. Phillips	Lot 3 Block 5 Ansley Park	6,600	167.53

<u>Name of Person on Assessment Roll</u>	<u>Description of Property</u>	<u>Area Assessed</u>	<u>Amount Assessment</u>
F. J. & Hazel C. Phillips	Lot 4 Block 5 Ansley Park	6,600	\$ 167.53
F. J. & Hazel C. Phillips	Lot 5 Block 5 Ansley Park	6,600	167.53
F. J. & Hazel C. Phillips	Lot 6 Block 5 Ansley Park	6,600	167.53
F. J. & Hazel C. Phillips	Lot 7 Block 5 Ansley Park	6,947	176.33
F. J. & Hazel C. Phillips	Lot 8 Block 5 Ansley Park	6,947	176.33
F. J. & Hazel C. Phillips	Lot 9 Block 5 Ansley Park	6,600	167.53
F. J. & Hazel C. Phillips	Lot 10 Block 5 Ansley Park	6,600	167.53
F. J. & Hazel C. Phillips	Lot 11 Block 5 Ansley Park	6,600	167.52
F. J. & Hazel C. Phillips	Lot 12 Block 5 Ansley Park	6,600	167.53
F. J. & Hazel C. Phillips	Lot 13 Block 5 Ansley Park	6,600	167.53
F. J. & Hazel C. Phillips	Lot 14 Block 5 Ansley Park	6,800	172.60
F. J. & Hazel C. Phillips	Lot 1 Block 4 Ansley Park	7,600	192.91
F. J. & Hazel C. Phillips	Lot 2 Block 4 Ansley Park	7,600	192.91
F. J. & Hazel C. Phillips	Lot 3 Block 4 Ansley Park	7,634	193.77
F. J. & Hazel C. Phillips	Lot 4 Block 4 Ansley Park	6,060	153.82
F. J. & Hazel C. Phillips	Lot 14 Block 4 Ansley Park	6,416	162.86
F. J. & Hazel C. Phillips	An area bounded by Marion St. R. R. St., 28th St. & 30th St.	84,330.4	2,140.54
Eilert & Ross Meling S. Marion St.	N. 125' of an area bounded by Marion St., R. R. St., 27th St. & 28th St.	23,957.50	608.11
Jack & Barbara Draper 1715 S. Hill Street	S. 75' of an area bounded by Marion St., R. R. St., 27th Ave. & 28th.	14,374.50	364.86
	GRAND TOTALS	2,586,914.70	\$65,663.16

Section 3: The Recorder is hereby directed to enter a statement of the assessments as above provided in the docket of City Liens and give notice thereof as provided by law.

Passed by the Council: November 27, 1957

Approved by the Mayor: November 27, 1957

W. L. DeLoach
Mayor

Effective Date: December 27, 1957

ATTEST:

Arthur D. Johnson
City Recorder

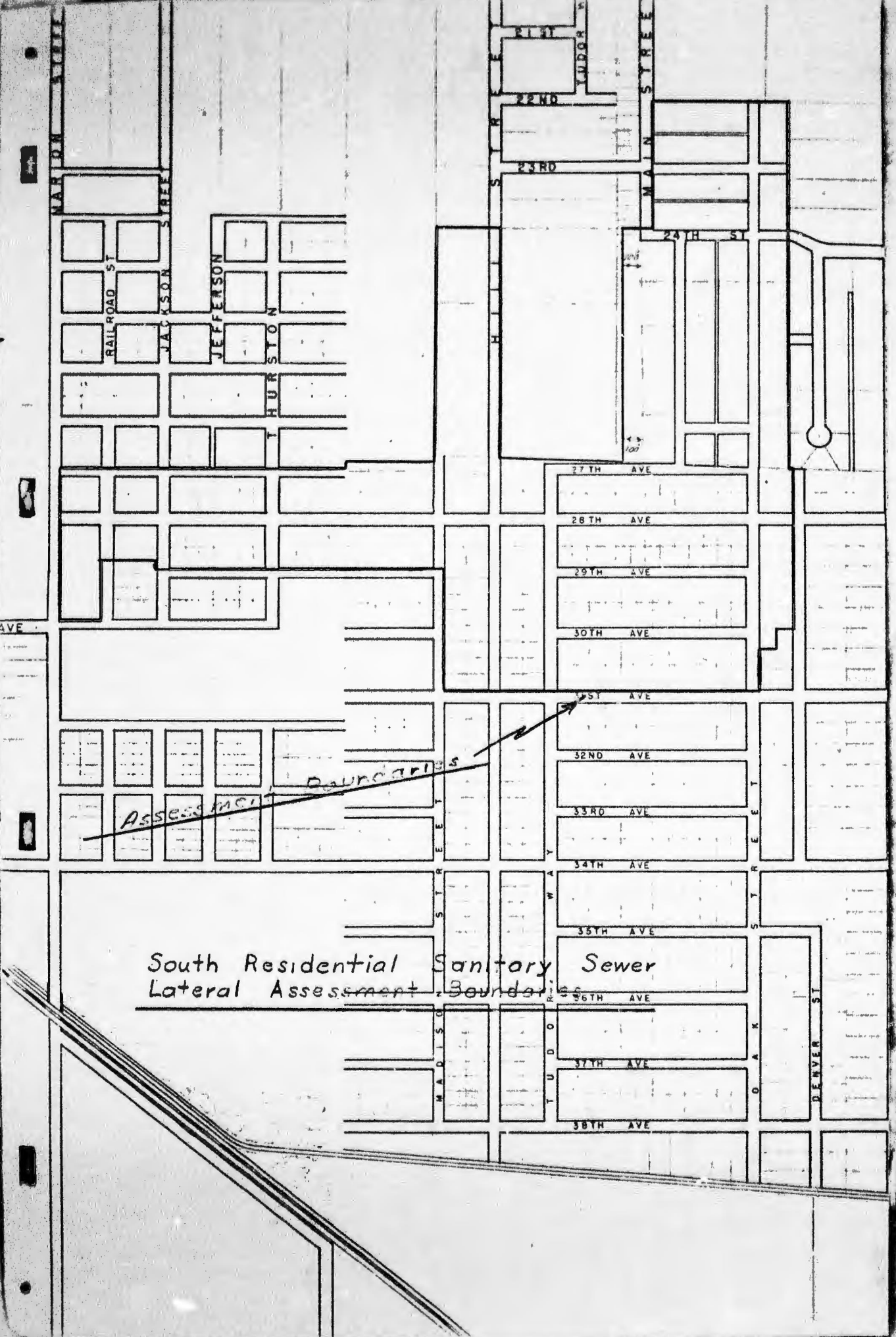

RAILROAD ST

JACKSON ST

JEFFERSON ST

HURSTON ST

HERRING ST

21ST

LUDOR ST

22ND

23RD

MAIN ST

24TH ST

27TH AVE

28TH AVE

29TH AVE

30TH AVE

31ST AVE

32ND AVE

33RD AVE

34TH AVE

35TH AVE

36TH AVE

37TH AVE

38TH AVE

MADISON ST

WATSON ST

DENVER ST

~~Assessment~~

~~Boundary~~

South Residential Sanitary Sewer
Lateral Assessment Boundaries

100

101