

ORDINANCE NO. 4811

AN ORDINANCE WITHDRAWING TERRITORY FROM THE ALBANY RURAL FIRE PROTECTION DISTRICT (FILE NO. AN-02-88).

WHEREAS, on March 23, 1988, the Albany City Council proclaimed the annexation of territory by adoption of Resolution No. 2767 and described in Exhibit A, attached hereto; and

WHEREAS, on March 23, 1988, the Albany City Council adopted Resolution No. 2768 setting a date for a public hearing concerning the withdrawal of said territory from the Albany Rural Fire Protection District; and

WHEREAS, notices of said public hearing were published and posted in the manner and for the time prescribed by law and on March 24, 1988, the Albany City Council did hold a public hearing during which time interested persons were given an opportunity to be heard on this matter; and

WHEREAS, the City Council following said public hearing determined that the withdrawal of territory from the District is in the best interests of the citizens of Albany.

NOW, THEREFORE, THE PEOPLE OF THE CITY OF ALBANY DO ORDAIN AS FOLLOWS:

Section 1: The following described territory to-wit: (see attached legal description, Exhibit A) is hereby proclaimed to be withdrawn from the Albany Rural Fire District.

Section 2: The City Recorder shall, within 10 days of the effective date of this ordinance, file a copy of the ordinance with the County Assessor of Linn County, Secretary of State of the State of Oregon, and the State of Oregon Department of Revenue.

Passed by the Council: April 13, 1988

Approved by the Mayor: April 14, 1988

Effective Date: May 13, 1988

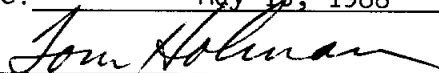

Mayor

ATTEST:

  
City Recorder

EXHIBIT 'A'

LEGAL DESCRIPTION FOR ANNEXATION

TO

THE CITY OF ALBANY, OREGON

Beginning at a point on the north right-of-way line of Santiam Highway (State Highway 20), which is 30.00 feet North and 2190.00 feet West of the northeast corner of the Edward N. White D.L.C. No.48, Township 11 South, Range 3 West, Willamette Meridian, Linn County, Oregon; thence South parallel to the east line of that parcel conveyed to Cummings Transfer Co., an Oregon Corporation by Assignment of Contract recorded in MF Volume 315, Page 675, Linn County Microfilm Records, 310.00 feet; thence East parallel with the south line of said Cummings Transfer parcel, 260.82 feet to the east line of that parcel conveyed to Samuel M. Ropp et al and described in deed recorded in MF Volume 78, Page 914, Linn County Microfilm Records; thence North on the east property line of said Ropp parcel, 310.00 feet to the north right-of-way line of Santiam Highway (State Highway 20), thence West on the north right-of-way line of Santiam Highway (State Highway 20), 260.82 feet to the point of beginning, containing 1.86 acres more or less.

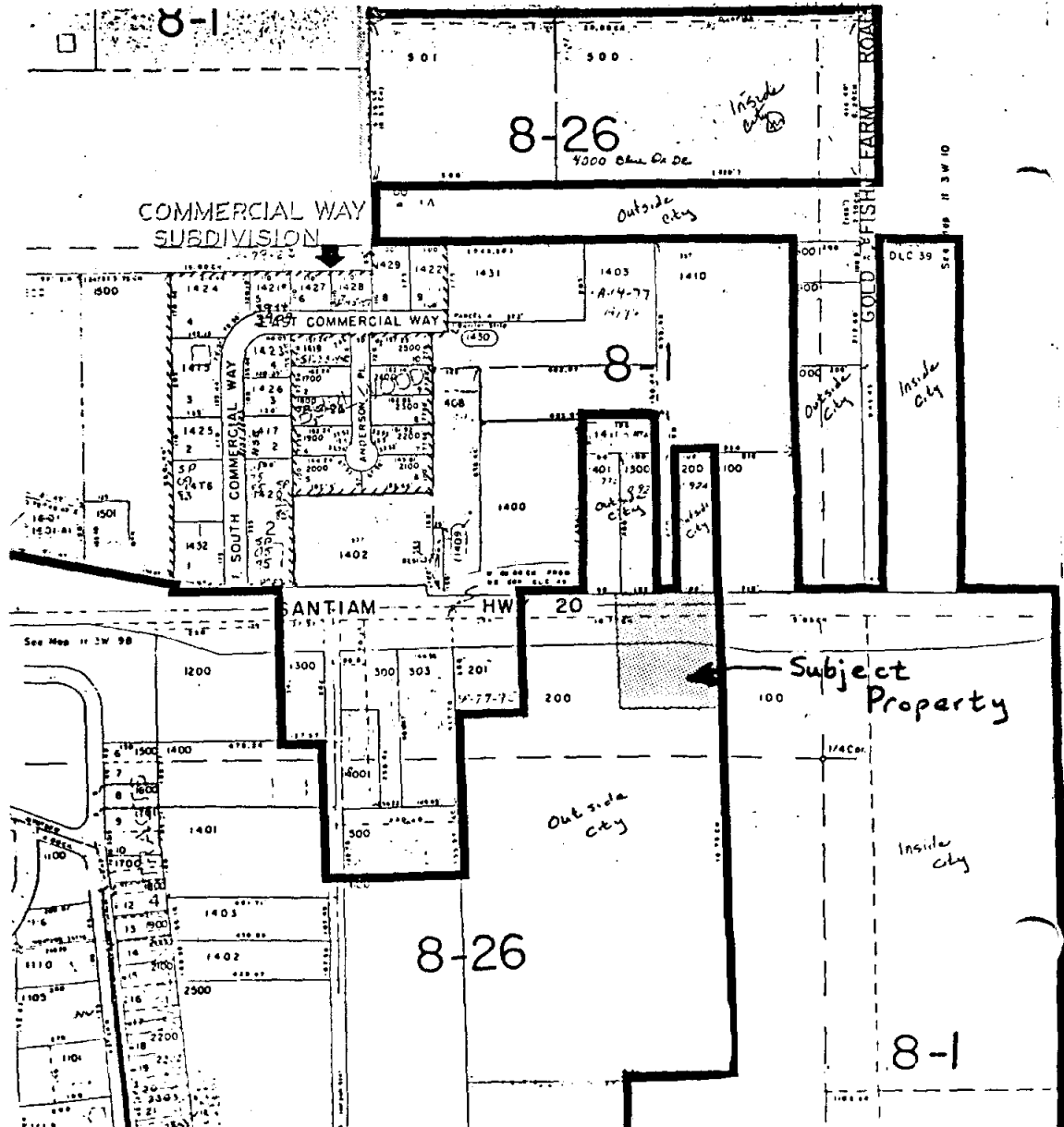

CASE No. AN-02-88