

RESOLUTION NO. 4520

A RESOLUTION ACCEPTING THE FOLLOWING DEDICATION DEED:

Grantor

Purpose

Robert Guse
Betty Guse

A permanent Dedication Deed described in attached
EXHIBIT A and as shown in attached EXHIBIT B.

NOW, THEREFORE, BE IT RESOLVED by the Albany City Council that it does hereby accept this
easement.

DATED THIS 10TH DAY OF OCTOBER, 2001.



Mayor

ATTEST:



City Clerk

DEDICATION DEED

Robert + Betty

KNOW ALL MEN BY THESE PRESENTS, that Guse's, hereinafter referred to as the Grantor, does dedicate to the City of Albany for street and utility right-of-way purposes situated in Linn County, State of Oregon, described as follows:

A tract of land as described in the attached description and as shown on Attached EXHIBIT A.

and covenants that the Grantor is the owner of the above described real property free of all encumbrances save and except reservations in patents and easements or record, and will warrant and defend the same against all persons who may lawfully claim the same.

The deed granted herein is in consideration of \$1.00, receipt of which is acknowledged by the Grantor, and in further consideration of the public improvements to be placed upon said property and the benefits grantors may obtain there from. Nothing herein shall reduce or limit grantors obligation to pay any costs or assessments, which may result from the improvements.

IN WITNESS WEREOF, the Grantors have hereunto affixed their signatures this 28th day of March, 2001.

GRANTOR:

GRANTOR:

Robert B Guse
Name Robert Guse

Betty Guse
Name Betty Guse

STATE OF OREGON)
County of Linn)
City of Albany)

STATE OF OREGON)
STATE OF OREGON)
City of Albany)

The foregoing instrument was acknowledged Before me this 28th-day of March, 2001 by his voluntary act and deed.

The foregoing instrument was acknowledged Before me this 28th-day of March, 2001 by his voluntary act and deed.

Matt Jew A. Ruettgers
Notary Public for Oregon
My Commission Expires: 2-05

Matt Jew A. Ruettgers
Notary Public for Oregon
My Commission Expires: 2-05

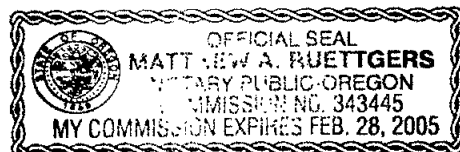
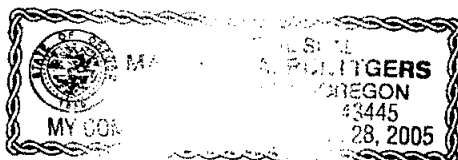

Return to: City of Albany - Recorder
P.O. Box 490, Albany, OR 97321

CITY OF ALBANY

STATE OF OREGON)
County of Linn)
City of Albany)

I, Steve Bryant as City Manager of the
City of Albany, Oregon, pursuant to Resolution
Number 4520, do hereby accept on
Behalf of the City of Albany, the above
Instrument pursuant to the terms thereof this
11 Day of October,
2001.

Steve Bryant
City Manager

ATTEST:

Margaret Laugwill
City Recorder Clerk

DEDICATION DEED TO THE CITY OF ALBANY
N-002

A portion of that certain tract of land described in Vol 1067 Page 957 of Linn County Deed of Records, described as follows:

Beginning at the southeast corner of said tract, thence a distance of 17 feet along its east line to a point; thence to a point lying on the southerly line of said tract and being 20 feet from its southeast corner; thence along said south line to the point of beginning. All lying in the SW ¼ of Section 17, Township 11 South, Range 03 West, Willamette Meridian, Linn County, Oregon and containing 170 square feet, more or less.

For reference purposes, this tract of land can be seen on tax assessors map 113W17CC tax lot 200, and on the attached exhibit 'A'.

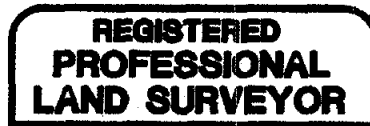

Leonard L. Smith



RENEWAL 6/30/2002

EXHIBIT 'A'
N-002

STREET ADDRESS 3312
TAX MAP 113W17CC
TAX LOT 200



SCALE: NTS

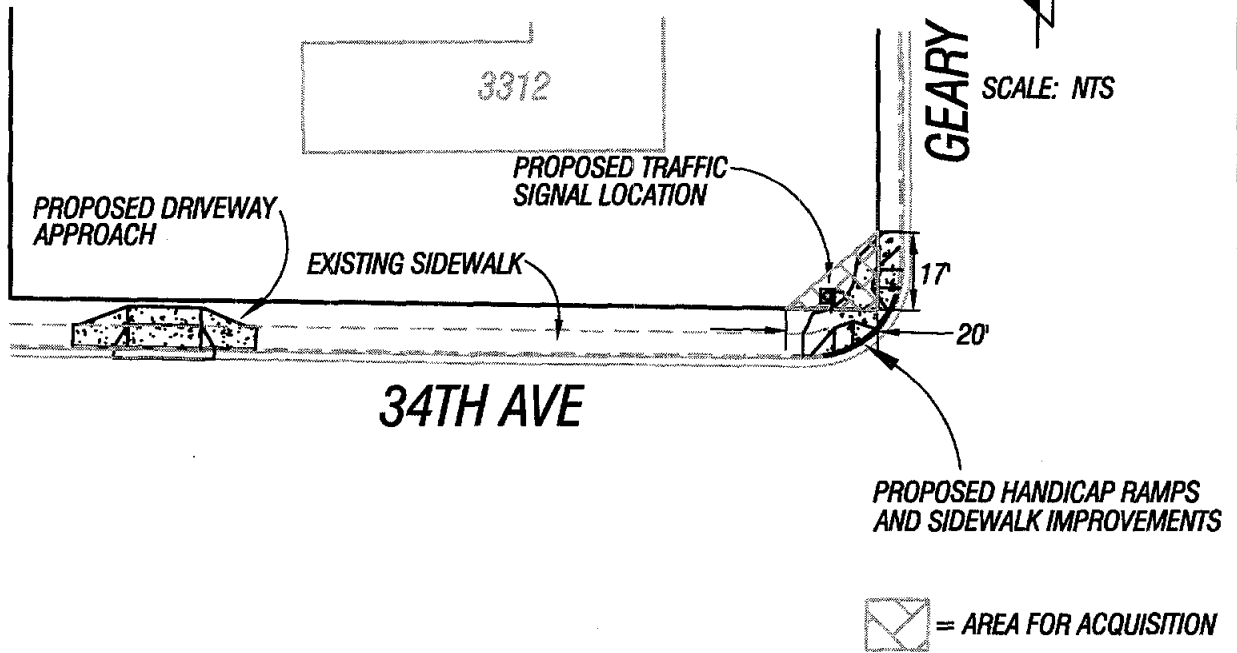

<p>REGISTERED PROFESSIONAL LAND SURVEYOR</p> <p><i>Leonard J. Smith</i></p> <p>OREGON SEPTEMBER 23, 1977 LEONARD J. SMITH 1329</p> <p>RENEWAL 6/30/2002</p>	<p>PacWest Engineering</p> <p>1530 NINTH AVE. SE TEL 1-888-926-7634 ALBANY, OR. 97321 FAX 541-926-7539</p>		<p><i>Project:</i> 99-051</p>
	<p><i>Client:</i> CITY OF ALBANY</p>		<p><i>Drawing No.:</i> ROWTAKES/BASE</p>
	<p><i>Drawn:</i> J. BLAINE</p>		<p><i>Date:</i> 02-22-01</p>
	<p><i>Field:</i> D. BECKER</p>		<p><i>Scale:</i> NTS</p>
	<p><i>Calc'd:</i> J. BLAINE</p>		<p><i>Checked:</i> L. SMITH</p>

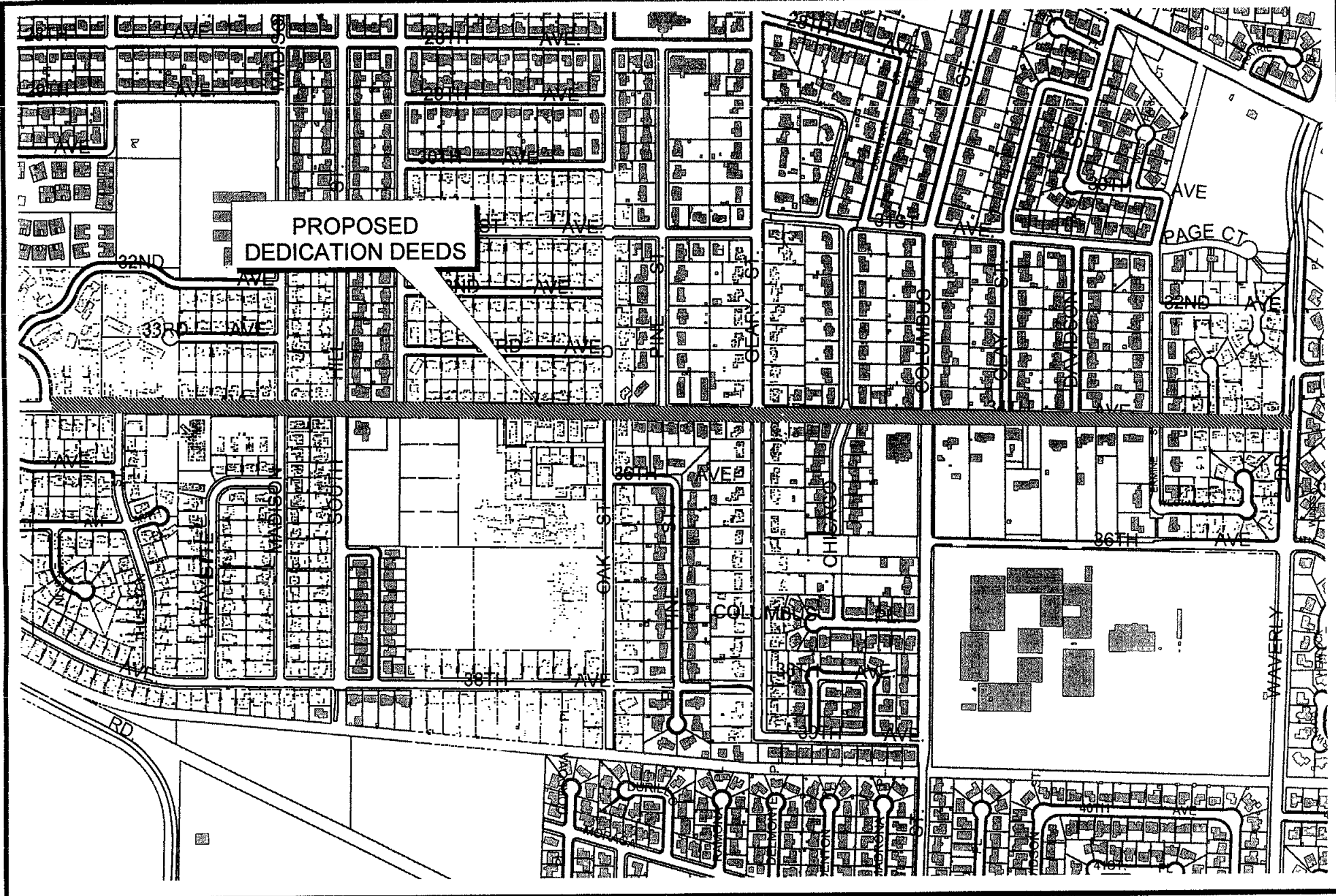

**PROPOSED
DEDICATION DEEDS**

VICINITY MAP

ST-01-01 34th Ave, Rehabilitation, Phase II



Dedication Deeds

Engineering - Angie

Mark Shepard

Sep 28, 2001

angies g:\engineer\gis\vicinity map apr

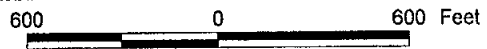

The City of Albany's Infrastructure records drawings and other documents have been gathered over many decades, using differing standards for quality control, documentation and verification. As the information provided represents current information in a readily available format. While the information provided is generally believed to be accurate, occasionally this information proves to be incorrect and thus its accuracy is not warranted. Prior to making any property purchases or other investments based in full or in part upon the information provided, it is specifically advised that you independently field verify the information contained within our records.



STATE OF OREGON
County of Linn

I hereby certify that the attached
was received and duly recorded
by me in Linn County records.

STEVE DRUCKENMILLER
Linn County Clerk

M. 2
S/D
ALL
o

MF 1226

By SL, Deputy PAGE 657

2001 OCT 22 P 1:57

46

Resolution No. 4520

Recorded Document Recorder File 3921