

Minor Land Disturbing Activity – Standard Requirements

1. 36 & PHDV UH V P VW EH L VWDOOHG L V F D PD HU DV W H V ODGH DWHU GHV W HWHU S DGMDFW W SU SHUWLHV U UI HWODGV U :DWHUV I W H 6WDWH
2. (36 & PHDV UH V W HODDV H PL LHH L UHIP W W FLS F VGLCW M LW H UL W H V W U FSWIUL G (36 & PHDV U H H S UDGHG HGHGHISHFWHG VW H H W W DHG W U F W M GLPHWH G LPH W O D GHW O F W M H VLWH
3. (36 & PHDV U H H V SHEW H O W SH U P O W H U P D G W D L H H G H D W D U H V U H H L E W L
4. 6 W D E L O L H G U D Y H O F V W U F W L H W U D F H V V D O O E H L V W D P D L W D L H G I U W H G U D W L I W H S U M H F W G G L W L D O P H D V S D Y H G D U H D V D U H H S W F O H D I U W H G U D W L I W H S U M H F W
5. (36 & PHDV U H H S M S O D W H S O U P D H W F U Y K E U V W D E O L V H G
6. (S V H G I P O V W S H U P D H W D E L O L H G D C O I D W M V E H I W H H (36 & S H U P L F D E H O V H G W 2 H F V L W D H L X O L H I O L D E M S G H W H I D O E L 3 H U P D H I W O V W D I E O I G H W G L V F D S L V F H H G L L H U S V I H G P L I O P P W L F O D H D U G F L S V
7. , W W S U S H U W U H V S V I W H L O I W W I D W S U S V H G G L I L O O H F D Y D W L W H U L W H G H W H D W L Y P S O F W D L S D M W W H U U P D G M S E H S W U W L H V

:HW :HDW HU 3HUPLW & GLWL V

1. :HWH DWHUUV S UHYH WL P H C O L H H I V F W 2 H W E H U U S U L O
2. 6 L O S V H G P U F W D W G D V D E H O Y H U H G L W S O P D W W I F D W U L F O D I P U O F E D U F L S V V D C W W W P I U L P I H H V S W H W L D O
3. (S V H G L O D E H O H H G I O G W H H S W H P E I O W L P E S U S H U P L D W L D G U W E H I W U H H W H D W H H D V

: H U H F D , H W D V V L V W D F H

:H D U H H H S W 6 W D W S L E D Y O O L I O D E O H D W S H H G D W W H U T H V W L S V H E D W D O W B E O L F V H S D U W I P H W W H L U & L W O O % U D G D O E L : H W F O : D H W F I D C O D H D U U D H P H D W M H H F V L W W D W L 7 H & L W , 6 P D S S I V H U Y D F D L O W E S L I E F L W I D O E D H W L I E) O G S O D L W D E H E W D I I H O (O D W WWS PVF IHPD Y HEDSS FV VW UHV VHUYOHW)HPD:HOF PH LH V OD ,G



EPSC Sample Site Plan

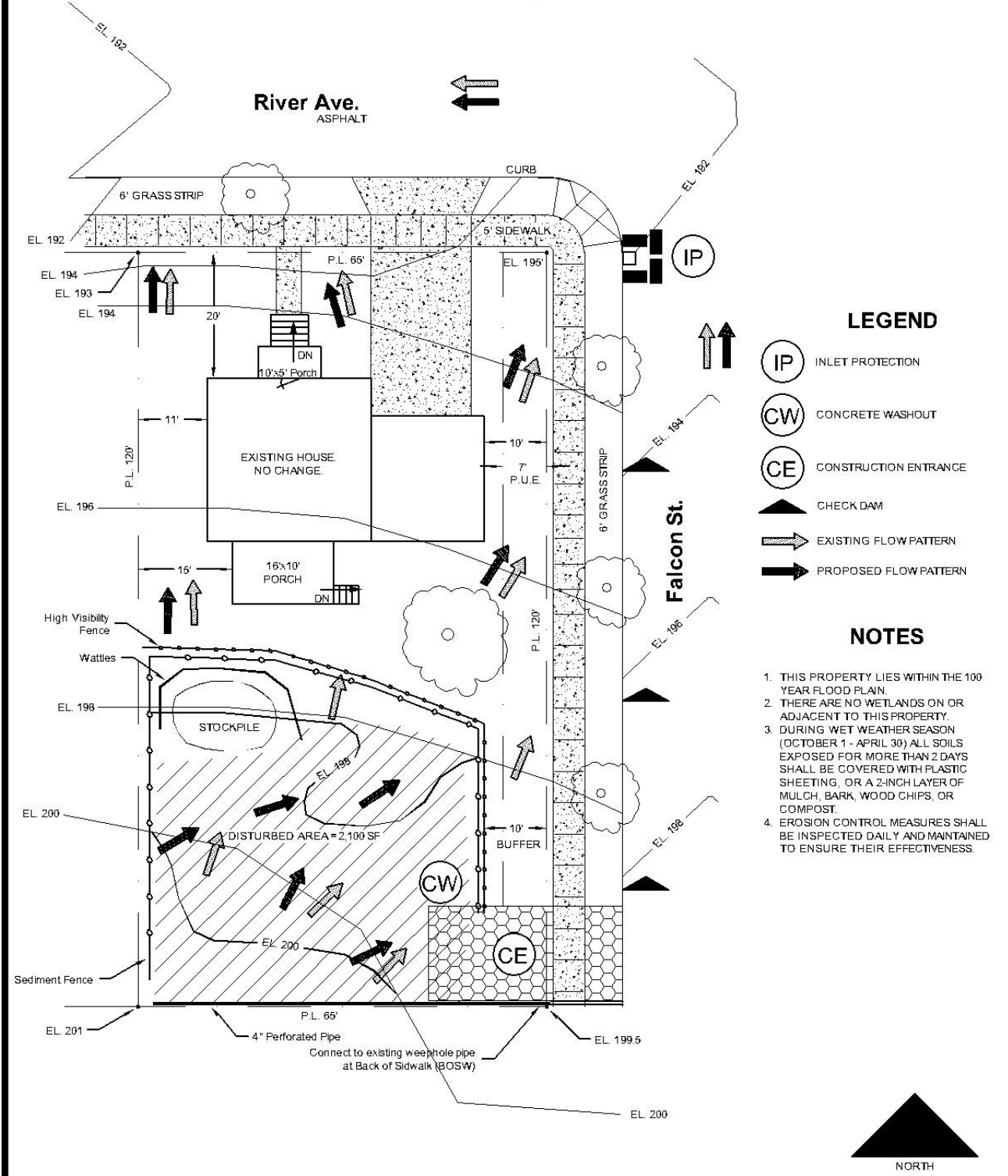

LEGEND

- IP INLET PROTECTION
- CW CONCRETE WASHOUT
- CE CONSTRUCTION ENTRANCE
- CHECK DAM
- EXISTING FLOW PATTERN
- PROPOSED FLOW PATTERN

NOTES

1. THIS PROPERTY LIES WITHIN THE 100 YEAR FLOOD PLAN.
2. THERE ARE NO WETLANDS ON OR ADJACENT TO THIS PROPERTY.
3. DURING WET WEATHER SEASON (OCTOBER 1 - APRIL 30) ALL SOILS EXPOSED FOR MORE THAN 2 DAYS SHALL BE COVERED WITH PLASTIC SHEETING, OR A 2-INCH LAYER OF MULCH, BARK, WOOD CHIPS, OR COMPOST.
4. EROSION CONTROL MEASURES SHALL BE INSPECTED DAILY AND MAINTAINED TO ENSURE THEIR EFFECTIVENESS.

Property Address:	123 River Ave., Albany, OR	Owner's Name:	John & Jane Doe
County Assessor's Parcel No:	11S04W12BC TL01106	Contractor Performing Work:	EPSC Excavating, Inc.
Erosion Prevention Sediment Control		Contact Name and Phone No:	Mel (541) 555-1234



City of Albany
 Public Works Department – Erosion Prevention & Sediment Control
 333 Broadalbin St. SW
 (541) 917-7676
 epsc@cityofalbany.net